

# On the Trail of Guildford's History

Be a history detective! Search Guildford Museum, Quarry Street and Guildford Castle to find clues which tell us about the past.

## In Guildford Museum

**1. Start upstairs in the Trade and Industry Gallery.** This part of the museum was built as a family home nearly 500 years ago, when Henry VIII was king. How do you think this room, the parlour, was heated? It was a private room for the owner and his wife.



Answer:.....

**2. The area with the shoes and the Childhood Gallery was one big room, the hall.** It's where the owners and their servants ate together.

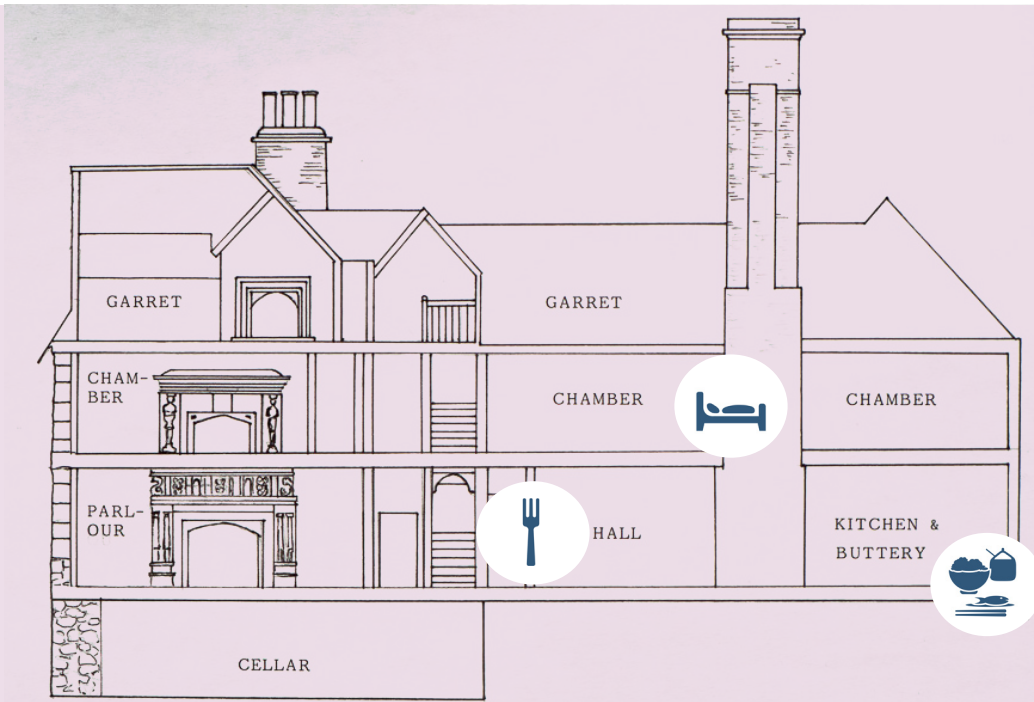

Look for the **wooden beams**. Many old houses in Guildford are made from wood as there were lots of oak trees in Surrey.

**3. In the Childhood Gallery look out of the window opposite the bottles** You are at ground level although you walked upstairs! Why is this?



Answer:.....

**4. Go into the Gertrude Jekyll and Lewis Carroll Gallery.** Look on the house plan above. Which room do you think this was?

Answer: .....

## In Quarry Street

**Leave the museum.** Carefully cross the road **with an adult** and look back at the museum. Spot the differences in this photo below and circle the missing bits.



**5. Walk towards the High Street. Stop at Olivo's restaurant.**

What do you notice about the first floor? This 'jetty' was common 400 years ago. Why do you think the builder did this?

**Answer:**.....

**Look opposite.**  
**Rosemary Alley** used to be a drain running to the river.

## At Guildford Castle



**6. Walk to the top of the mound and stand outside the castle.**

The castle has big windows to let in light. They were put in when the castle was several hundred years old. The narrow windows were there when it was built. What do you think the narrow windows were for?

**Answer:** .....

**Look at the view.** Can you spot these buildings?



- The square church towers of St. Mary's (flint) and St. Nicholas' (brick)
- Guildford Cathedral

- St. Catherine's Chapel (on a small hill)
- Walls in the gardens: remains of a royal palace on this site

**Do you know which one is the newest?**

**Answer:** .....